

治具自动快换 FIXTURE AUTOMATIC QUICK CHANGER

OQT-10 治具自动快换

OQT-10 Fixture automatic quick changer

- 建议负载 10kg;
- 采用钢球锁紧方式;
- 内置在位检测装置;
- 具有防尘功能;
- 体积小重量轻;
- 采用机械式自锁设计;
- 防止气源意外切断时两侧分离。

- Payload capacity 10kg;
- Steel ball lock system;
- Grasp detecting device inside;
- With dustproof function;
- Small volume light weight;
- Adopt the mechanical self-locking design;
- Prevent separation from separating when when source of cut off.

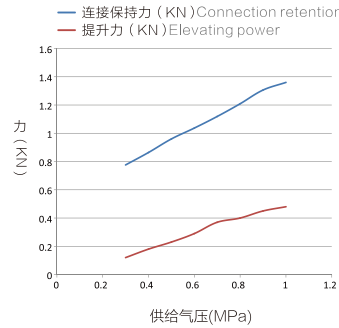

QQT-10 continuous relay and lifting force curve

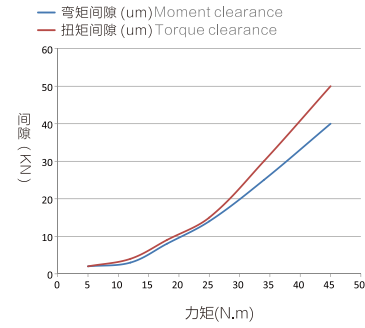

QQT-10 Bending moment and torque changer curve

规格参数 Specifications

本体部分 Mainbody	可搬运重量(额定负载)Payload capacity	10kg		
	位置重复精度 Positon repeatability	± 0.02mm		
	静态允许力矩 Static allowable torque	弯矩方向 Bending direction(Mx.My)	24.9N.m	
		扭矩方向 Torque direction(Mr)	33.9N.m	
	锁紧力 (当气压 0.49Mpa时)Tight locking force (When the air pressure is 0.49Mpa)	1000N		
	材质 Materialv	本体 Main body	铝合金 Aluminum alloy	
		锁紧机构部分 Locking mechanism	合金钢 Alloy steel	
	外形尺寸(锁紧时Lock) Housing diameter(Lock when locked)	75 x 75 x H41mm		
	产品重量 Product weight	机器人侧 Robot side	0.46kg	
		工具侧 Tool side	0.21kg	
拆装结构 Disassembling institutions	钢球定位锁紧 Steel ball position lock			
拆装动作气压 Disassembling action pressure	0.39~0.7MPa(4~7kgf/cm ²)			
允许温度与湿度范围 Allowable temperature and humidity range	0~55℃, 0~95%(不结露No condensation)			
通用 General	通气孔 Pneumatic port	M5 x 4个		
控制部分 Control body	面结合确认 Face-to-face confirmation	确认快换两侧盘面锁紧 Confirm both sides of the disk are locked	内置1个光电传感器(直流3线式) Built-in 1 photoelectric sensor	
	组件 Component (选配 Option)	通用 General	电信号点 Electrical signal	2A x 9 PIN

模块参数 Module parameter

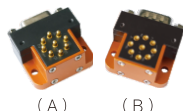
型号 Model	使用于 Used in	工作电压 Operating voltage	工作电流 Working current	电插针 Electric pin	订货编号 Order number	单价 Price	接插件 Connector	订货编号 Order number	单价 Price
	机器人侧 Robot side	24V	2A	9Pin	7.03.03.0011		PTXZ01-9P-A	7.03.03.0014	
	工具侧 Tool side				7.03.03.0012		PTXZ01-9P-B	7.03.03.0013	

外形尺寸 OVERALL DIMENSIONS

机器人侧: OQT-10A
Robot side
订货编号: 7.03.13.0005
Order number
单价:
Price

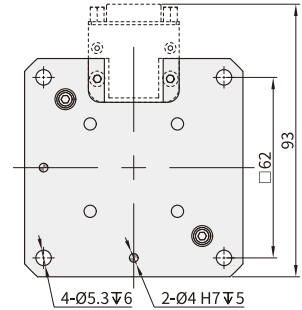
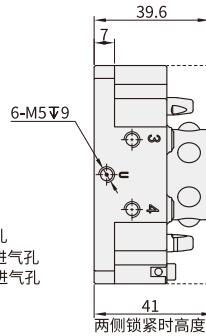
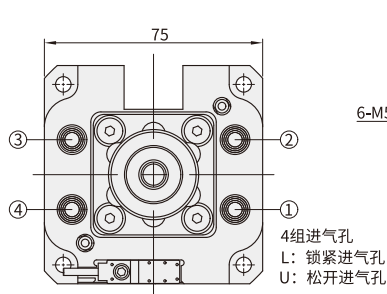
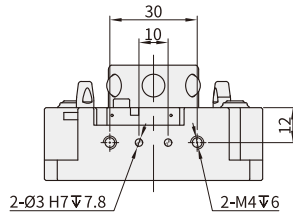
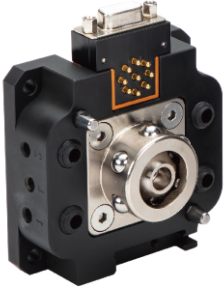

工具侧: OQT-10B
Tool side
订货编号: 7.03.13.0006
Order number
单价:
Price

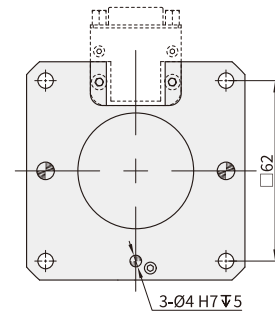
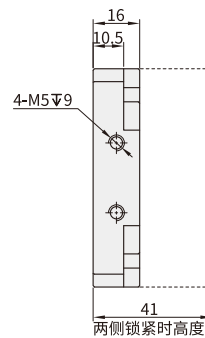
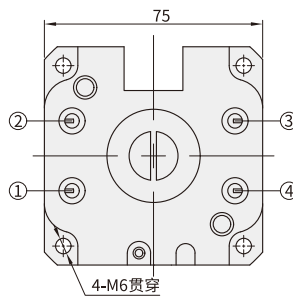
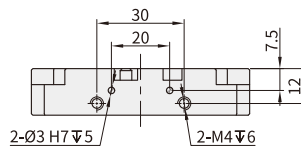

安装说明 INSTALLATION DESCRIPTION

