

## OQC-015机器人自动快换 OQC-015 Robot automatic quick changer

- 载重15kg;
  - 采用钢球锁紧方式;
  - 采用机械式自锁设计;
  - 防止气源意外切断时两侧分离。
- Payload capacity 15 kg;
  - Steel ball lock system;
  - Adopt the mechanical self-locking design;
  - Prevent separation separation from separating when when source of cut off.

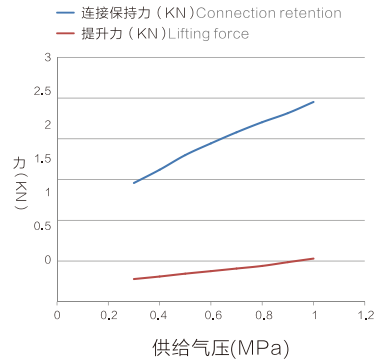

OQC-015连续继电器、提升力曲线图  
OQC-015 Continuous relay, lifting force curve

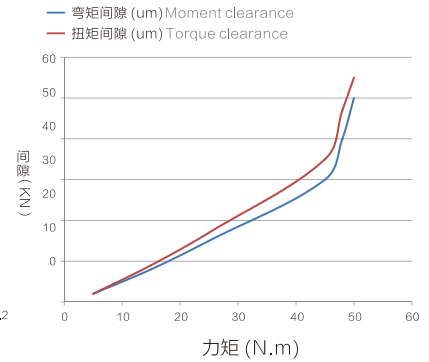

OQC-015弯矩、扭矩变位曲线图  
OQC-015 Bending moment and torque changer curve

### 规格参数 Specifications

本体部分 Mainbody	可搬运重量(额定负载)Payload capacity	15kg		
	位置重复精度 Position repeatability	±0.02mm		
	静态允许力矩 Static allowable torque	弯矩方向 Bending direction( Mx.My)	45N.m	
		扭矩方向 Torque direction( Mr)	48N.m	
	锁紧力(当气压 0.49Mpa时)Tight locking force (When the air pressure is 0.49Mpa)	1800N		
	材质 Material	本体 Main body	铝合金 Aluminum alloy	
		锁紧机构部分 Locking mechanism	合金钢 Alloy steel	
	外形尺寸(锁紧时Lock) Housing diameter(Lock when locked)	Φ68mmxH48.5mm		
	产品重量 Product weight	机器人侧 Robot side	0.27kg	
		工具侧 Tool side	0.18kg	
拆装结构 Disassembling institutions	钢球定位锁紧 Steel ball position lock			
拆装动作气压 Disassembling action pressure	0.39~0.7MPa(4~7kgf/cm <sup>2</sup> )			
允许温度与湿度范围 Allowable temperature and humidity range	0~55℃, 0~95%(不结露No condensation)			
通用 General	通气孔 Pneumatic port	M5 x10个		
组件 Component (选配 Option)	通用 General	电信号点 Electrical signal	5A x12PIN/2A x19PIN	

### 模块参数 Module parameter

型号 Model	使用于 Used in	工作电压 Operating voltage	工作电流 Working current	电插针 Electric pin	订货编号 Order number	单价 Price	接插件 Connector	订货编号 Order number	单价 Price
PTL05-12P-I-A	机器人侧 Robot side	50V	5A	12Pin	7.03.01.0154		PTLZ05-12P-I-A	7.03.01.0138	
	工具侧 Tool side				7.03.01.0155		PTLZ05-12P-I-B	7.03.01.0139	
PTL02-19P-I-A	机器人侧 Robot side		2A	19Pin	7.03.01.0156		PTLZ02-19P-I-A	7.03.01.0140	
	工具侧 Tool side				7.03.01.0157		PTLZ02-19P-I-B	7.03.01.0141	

# 机器人自动快换 ROBOT AUTOMATIC QUICK CHANGER

## 外形尺寸 OVERALL DIMENSIONS

机器人侧: OQC-015-A  
Robot side  
订货编号: 7.03.01.0005  
Order number  
单价:  
Price

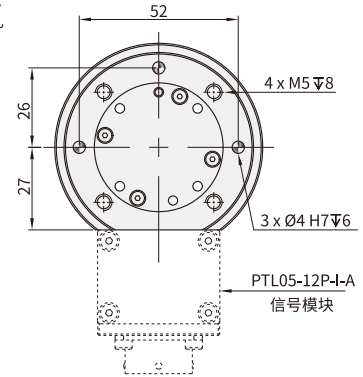
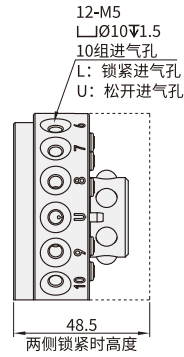
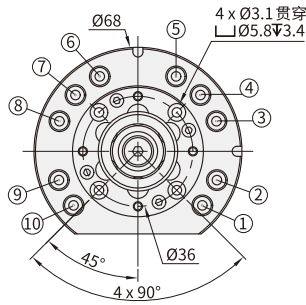
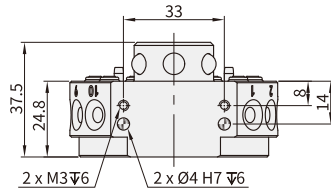

工具侧: OQC-015-B  
Tool side  
订货编号: 7.03.01.0006  
Order number  
单价:  
Price

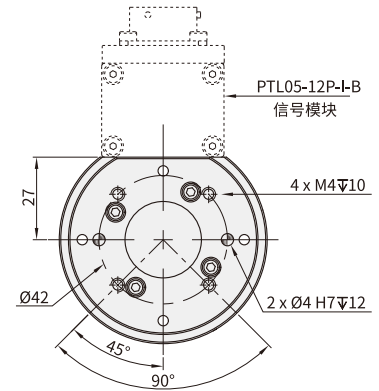
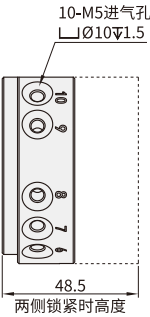
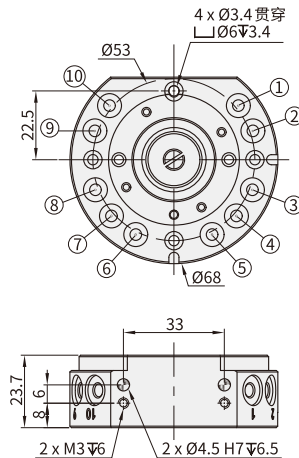
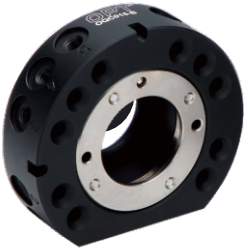

## 安装说明 INSTALLATION DESCRIPTION

机器人手臂 Robot arm

连接法兰 Connecting flange

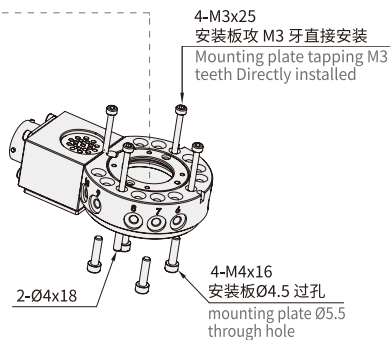
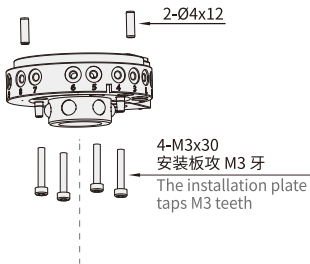

电气连接器: PTL05-12P-I-A  
Electrical connector PTL02-19P-I-A

电气连接器: PTL05-12P-I-B  
Electrical connector PTL02-19P-I-B

